

“\*” Pivot Dimension

RoHS Component

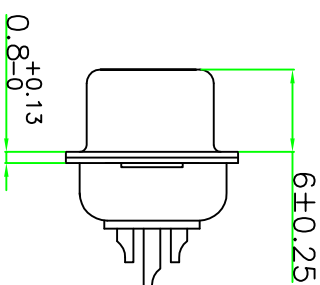
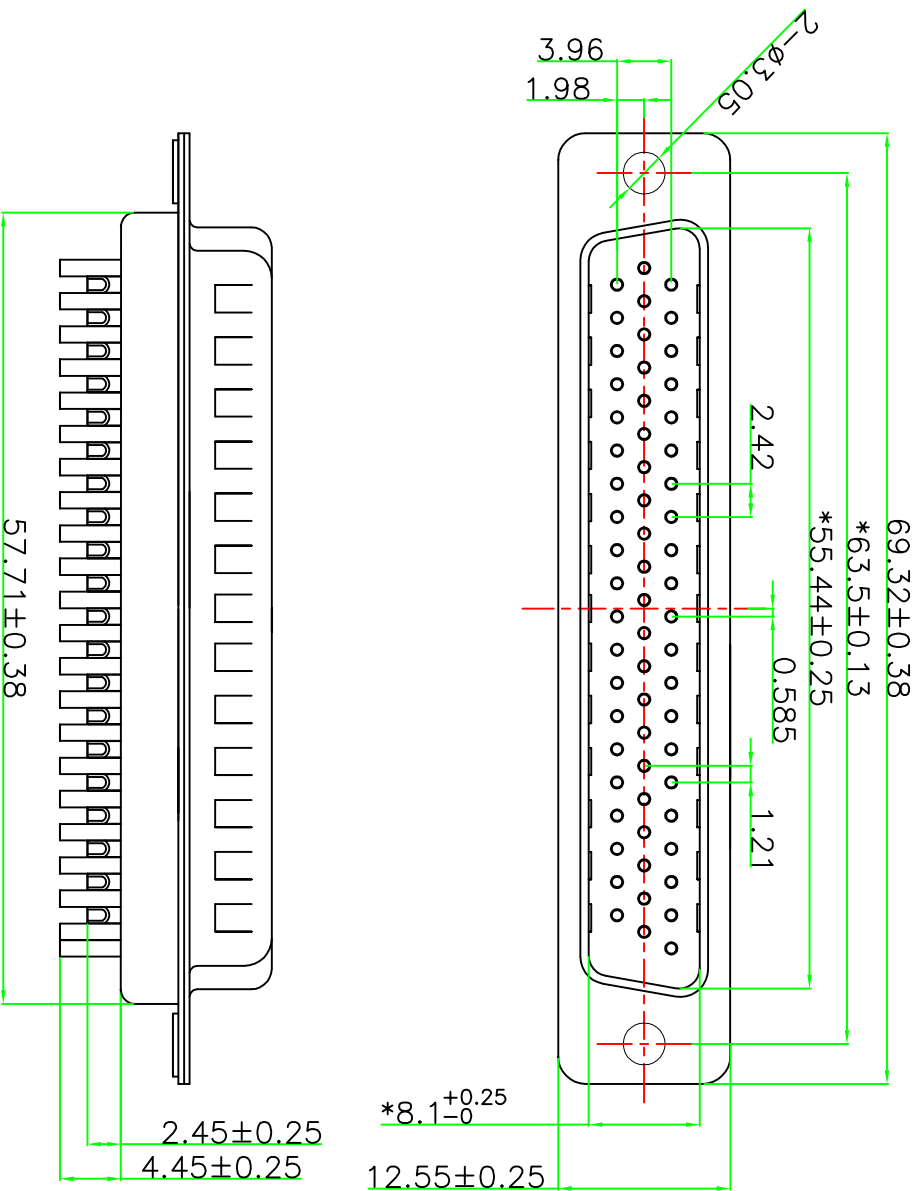

NOTICE :

1. ELECTRIC:

DIELECTRIC RATING: 300V

CONTACT CURRENT RATING: 3AMP

CONTACT RESISTANCE:  $15m\Omega$  MAX.

INSULATION RESISTANCE:  $1000M\Omega$  MIN. AT 500V DC

DIELECTRIC STRENGTH: 500V AC RMS FOR 1MINUTE

OPERATION TEMPERATURE:  $-55C^{\circ} \sim 125C^{\circ}$

2. MATERIAL:

INSULATOR: PBT+30% G.F (UL94V-0)

CONTACT: COPPER ALLOY

CONTACT PLATED: GOLD FLASH OVER NICKEL

SHELL: SPCC

SHELL PLATED: NICKEL/TIN



东莞市迅颖原精密连接器有限公司  
Dongguan Signalorigin Precision Connector Co., Ltd

|   |  |   |  |   |  |
|---|--|---|--|---|--|
| <b>TOLERANCE:</b><br>XX $\pm 0.38$<br>XXX $\pm 0.25$<br>XXXX $\pm 0.13$ |  | <b>DRAWN BY :</b> 杨冬梅<br><b>DATE :</b> 2009.12.16   |  | <b>PART NAME:</b><br>HDB 62 公 焊线式传统聊合     |  |
| <b>UNIT:</b> mm [inch]<br>X° ±9° XX° ±1°                                |  | <b>CHECKED BY :</b> 杨剑玉<br><b>DATE :</b> 2014.11.05 |  | <b>DRAW NO.:</b> XHV-06-0191              |  |
| <b>SCALE:</b> 1:1<br>A版   |  | <b>APPROVED BY :</b> 胡超<br><b>DATE :</b> 2014.11.05 |  | <b>PART NO.:</b> HDB062MH0000009000000000 |  |
|   |  |   |  | <b>REMARK</b>                             |  |
|   |  |   |  | <b>MOLD NO.</b>                           |  |