

标“*”为重点检验尺寸

所用物料均符合ROHS标准

| 版本 | 变更人 | 变更内容 |
|----|-----|------|
| | | |
| | | |

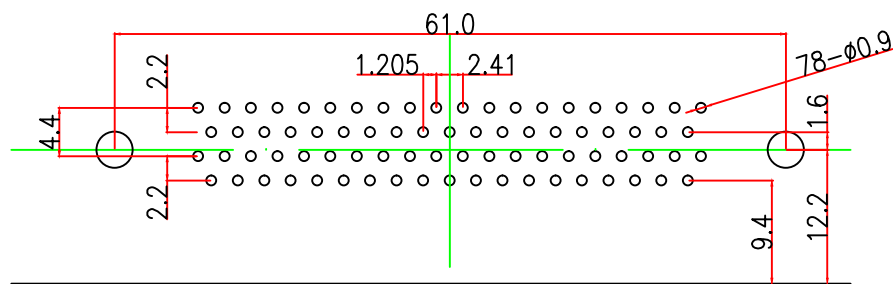
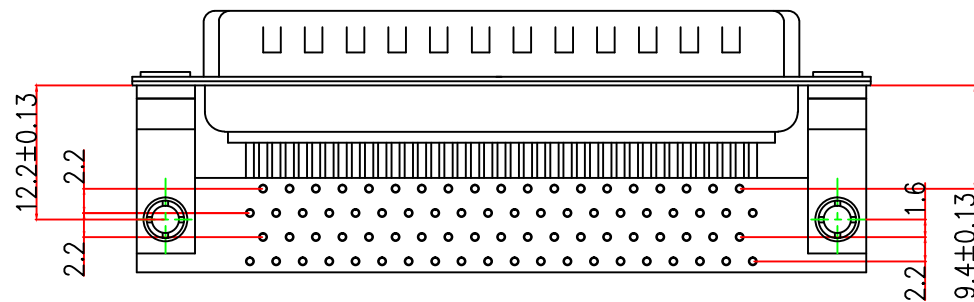
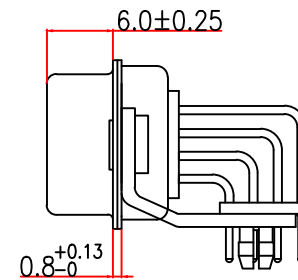
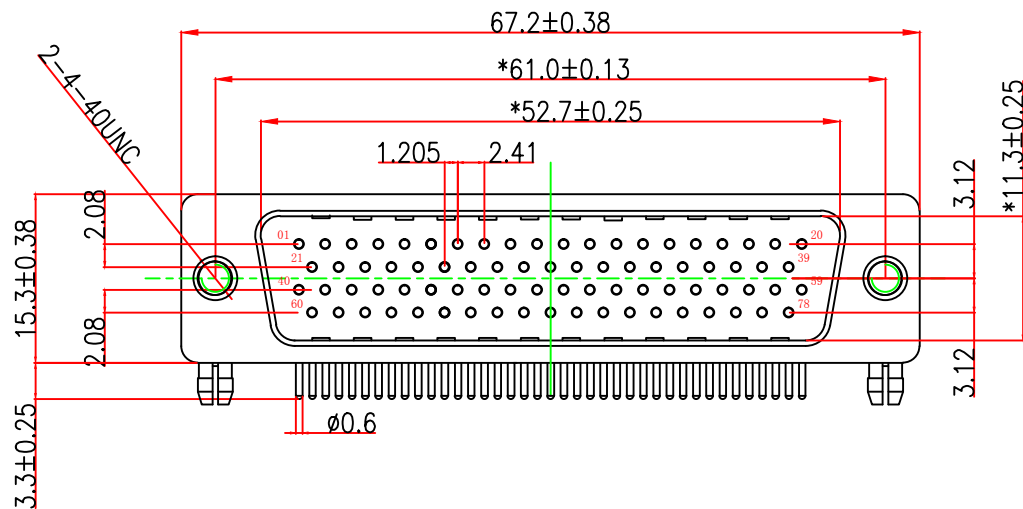

PCB LAYOUT

NOTICE :

- ELECTRICE:
 - DIELECTRIC RATING: 300V
 - CONTACT CURRENT RATING: 3AMP
 - CONTACT RESISTANCE: 15mΩ MAX.
 - INSULATION RESISTANCE: 1000MΩ MIN. AT 500V DC
 - DIELECTRIC STRENGTH: 500V AC RMS FOR 1MINUTE
 - OPERATION TEMPERATURE: -55°C ~125°C
- MATERIAL:
 - INSULATOR: PBT+30% G. F (UL94V-0)
 - CONTACT: COPPER ALLOY
 - CONTACT PLATED: GOLD FIASH OVER NICKEL
 - SHELL: SPCC
 - SHELL PLATED: NICKEL/TIN



东莞市迅颢原精密连接器有限公司

Dongguan Signalorigin Precision Connector Co.,Ltd

| | | | | | |
|--|---------------------------|-------------------------------|---|------------------------|--|
| TOLERANCE: XX ±0.30 X.XX ±0.10 X.XXX ±0.05 X.* ±5° X.X* ±2° | DRAWN BY : 杨剑玉 | 2015. 05. 15 | PART NAME: HDR 78 公 弯焊板式铆12.2支架锁纤维板 | | |
| | CHECKED BY: 侯应文 | DATE : 2015. 05. 15 | DRAW NO. | XHY-06-0068 | |
| UNIT: mm [inch] SCALE:1:1 SIZE: A4 | APPROVED BY: 胡超 | DATE : 2015. 05. 15 | PART NO. | HDR078MH23000924000000 | |
| | 2015. 05. 15 | REMARK | H=9.4 | | |
| 2015. 05. 15 | MOLD NO. | / | | | |