

RoHS Component

“*” Pivot Dimension

P0(XXX)	A ±0.25	B ±0.13	C ±0.38	D ±0.25
009	16.92	24.99	30.81	19.28
015	25.25	33.32	39.14	27.51
025	38.96	47.04	53.04	41.28
037	55.42	63.50	69.32	57.71

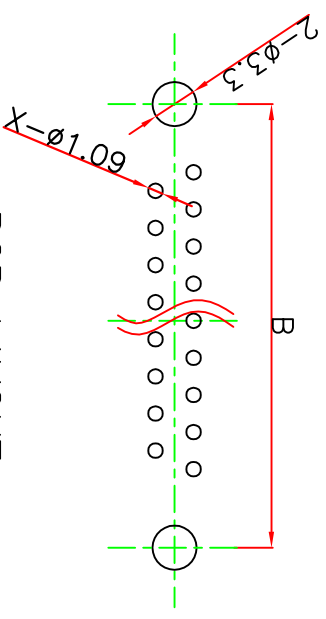
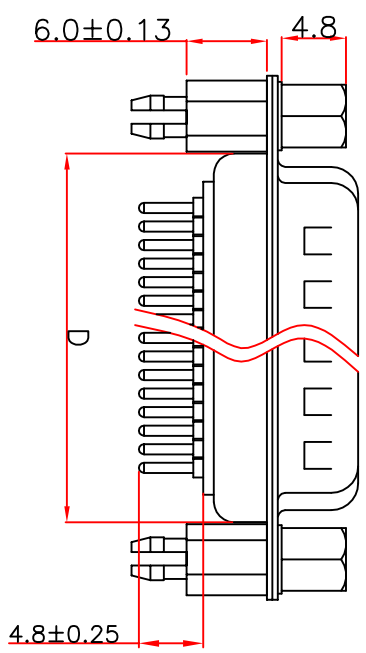
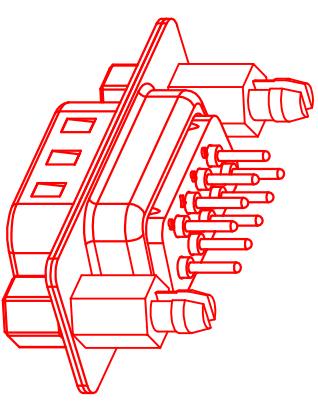
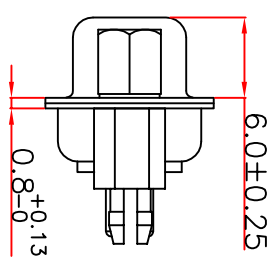
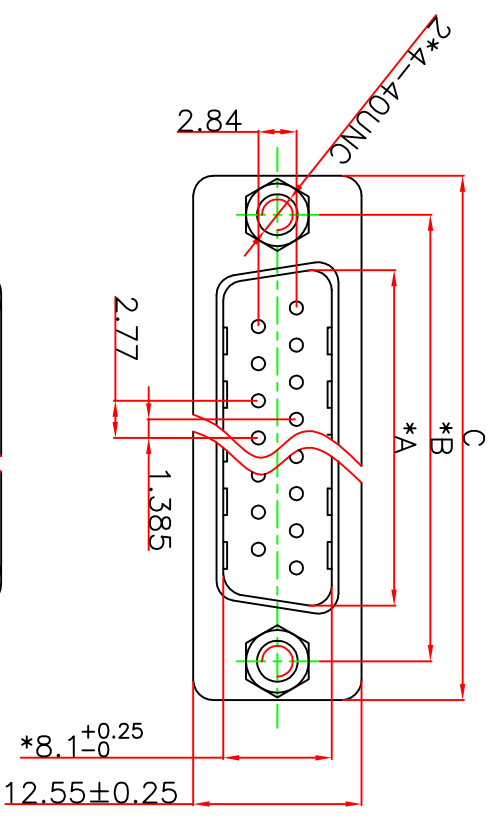

PCB LAYOUT

NOTICE :

- ELECTRICE:
 - DIELECTRIC RATING: 300V
 - CONTACT CURRENT RATING: 5AMP
 - CONTACT RESISTANCE: 15mΩ MAX.
 - INSULATION RESISTANCE: 1000MΩ MIN. at 500V DC
 - DIELECTRIC STRENGTH: 500V AC RMS for 1minute
 - OPERATION TEMPERATURE: -55°C ~ 125°C
- MATERIAL:
 - INSULATOR: PBT+30% G.F (UL94V-0)
 - CONTACT: COPPER ALLOY
 - CONTACT PLATED: GOLD FLASH OVER NICKEL
 - SHELL: SPCC
 - SHELL PLATED: NICKEL/TIN
 - FORK: COPPER ALLOY/PLATED NICKEL



东莞市迅颢原精密连接器有限公司
Dongguan Signalorigin Precision Connector Co.,Ltd

TOLERANCE: XX ±0.38 XXX ±0.25 XXXX ±0.13 X*.45° XX*.45°		DRAWN BY : 杨冬梅 DATE : 2009.08.22		PART NAME: DP XP 公 直焊板式铆6.0鱼叉 锁4-40UNC*4.8螺丝	
CHECKED BY : 杨冬梅 DATE : 2009.08.22		APPROVED BY DATE : 胡超 2009.08.22		SCALE: 1:1 SIZE: A4	
UNIT: mm [inch]		APPROVED BY DATE : 胡超 2009.08.22		REMARK PDPXXXXMH2600009XXXXX000	
SCALE: 1:1 SIZE: A4		APPROVED BY DATE : 胡超 2009.08.22		MOLD NO.	