

“*” Pivot Dimension

RoHS Component

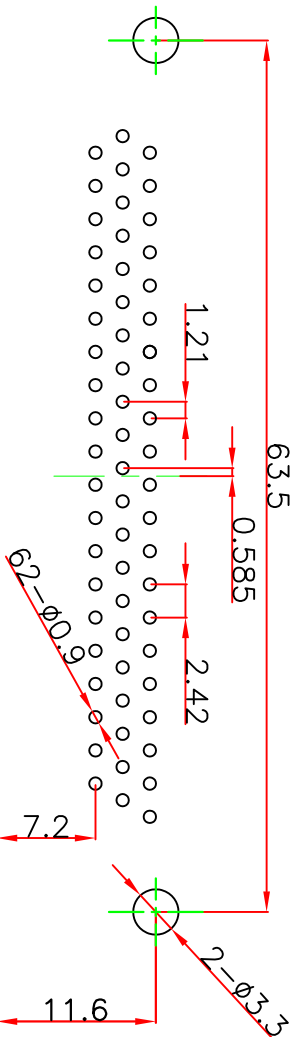
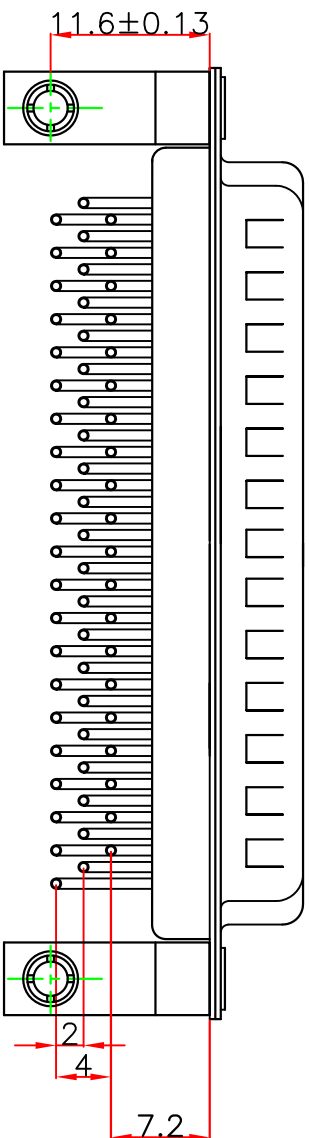
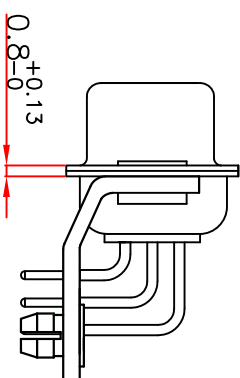
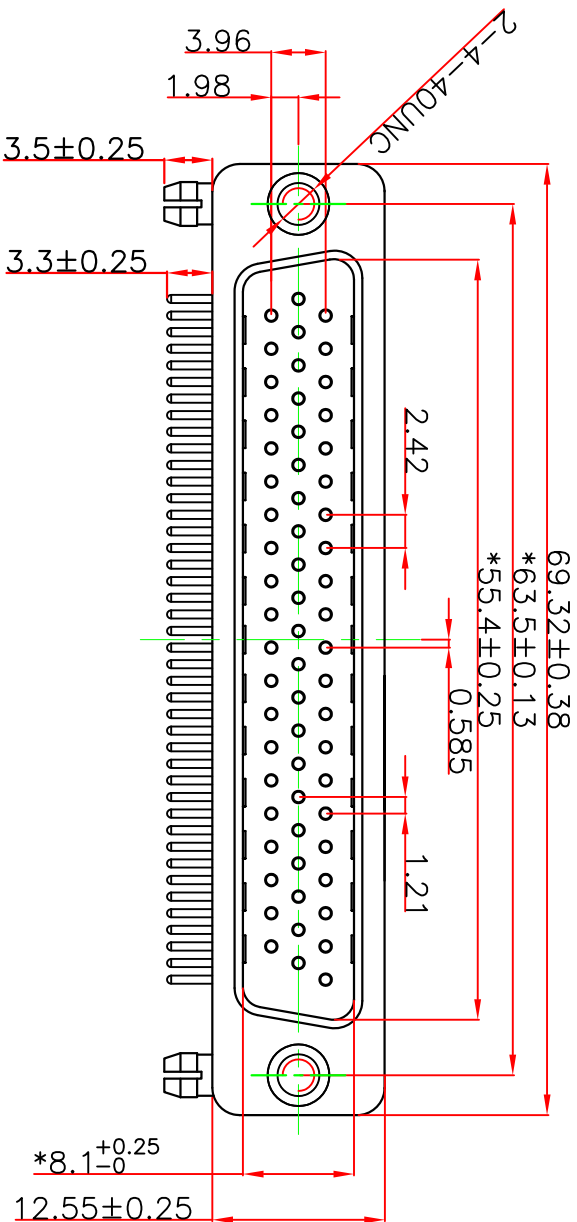

PCB LAYOUT

NOTICE :

1. ELECTRICICE:
 - DIELECTRIC RATING: 300V
 - CONTACT CURRENT RATING: 3AMP
 - CONTACT RESISTANCE: 15mΩ MAX.
 - INSULATION RESISTANCE: 1000MΩ MIN. at 500V DC
 - DIELECTRIC STRENGTH: 500V AC RMS FOR 1MINUTE
 - OPERATION TEMPERATURE: -55C° ~125C°
2. MATERIAL:
 - INSULATOR: PBT+30% G. F (UL94V-0)
 - CONTACT: COPPER ALLOY
 - CONTACT PLATED: GOLD FLASH OVER NICKEL
 - SHELL: SPCC
 - SHELL PLATED: NICKEL/TIN
 - BRACKET: COPPER ALLOY PLATED Ni

东莞市迅颢原精密连接器有限公司

Dongguan Signalorigin Precision Connector Co.,Ltd

		TOLERANCE: XX ±0.38 XXX ±0.25 XXXX ±0.13 X* ±5° XX* ±1°	
DRAWN BY : 杨冬梅 DATE : 2009.12.16 CHECKED BY : 杨剑玉 DATE : 2014.11.05 APPROVED BY : 胡超 DATE : 2014.11.05		PART NAME: HDR 62 公 弯焊板式插11.6支架 H=7.2 DRAW NO.: XHY-06-0203 PART NO.: HDR062MH110000900000072	
UNIT: mm [inch] SCALE: 1:1 A版		REMARK MOLD NO.	