

所用物料符合ROHS标准

标“*”为重点检验尺寸

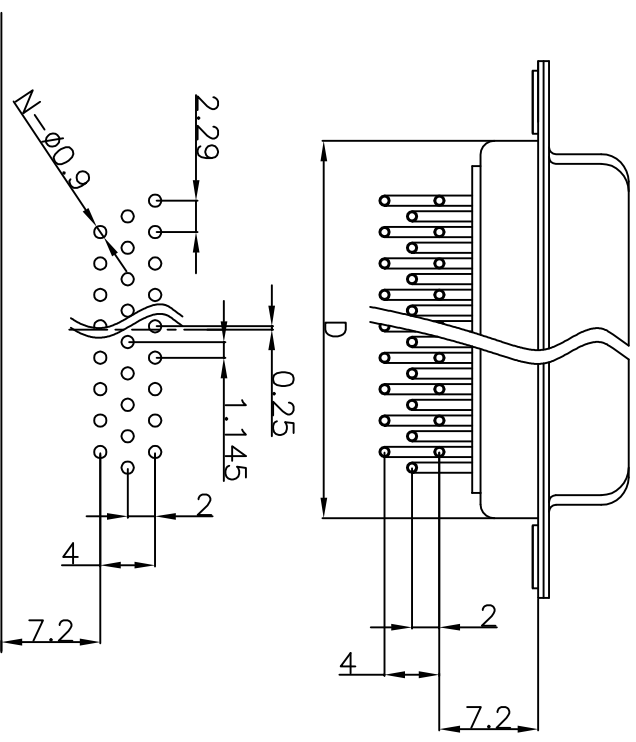
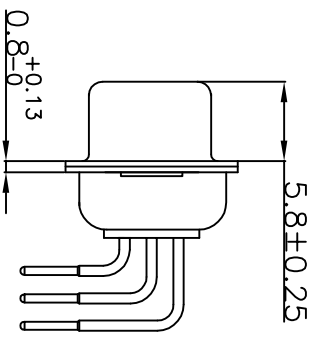
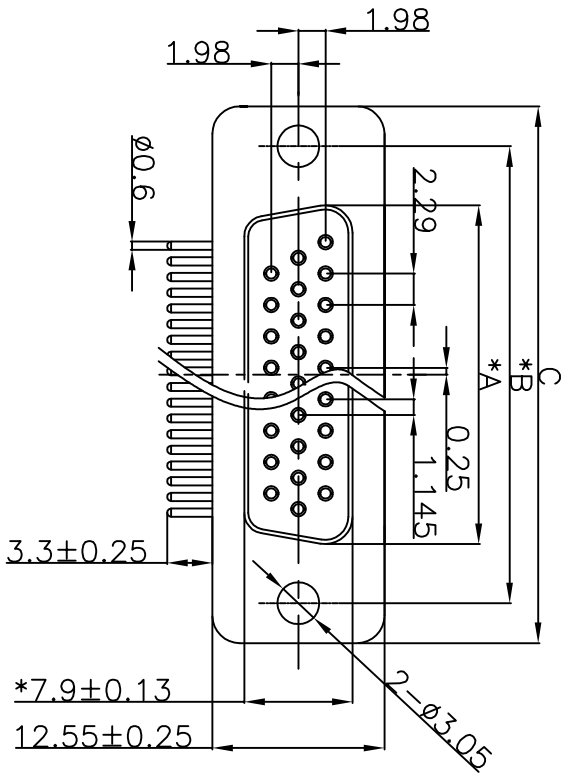

P0(XXX)	A ±0.25	B ±0.13	C ±0.38	D ±0.25
015	16.33	24.99	30.81	19.28
026	24.66	33.32	39.14	27.51
044	38.38	47.04	53.04	41.28

NOTICE :

1. ELECTRIC:
 DIELECTRIC RATING: 300V
 CONTACT CURRENT RATING: 3AMP
 CONTACT RESISTANCE: 15mΩ MAX.
 INSULATION RESISTANCE: 1000MΩ MIN. AT 500V DC
 DIELECTRIC STRENGTH: 500V AC RMS FOR 1MINUTE
 OPERATION TEMPERATURE: -55C° ~ 125C°

2. MATERIAL:
 INSULATOR: PBT+30% G. F (UL94V-0)
 CONTACT: COPPER ALLOY
 CONTACT PLATED: GOLD FLASH OVER NICKEL
 SHELL: SPCC
 SHELL PLATED: NICKEL/TIN

东莞市迅颢原精密连接器有限公司
 Dongguan Signalorigin Precision Connector Co., Ltd

TOLERANCE: XX ±0.38 XXX ±0.25 XXXX ±0.13 X* ±0.25 XX* ±0.25		DRAWN BY : 杨剑玉 DATE : 2011.01.05 CHECKED BY : 杨剑玉 DATE : 2011.01.05 APPROVED BY : 胡超 DATE : 2014.11.05		PART NAME: HDR XP 母 弯焊板式传统耦合 H=7.2 DRAW NO.: XHV-06-0114 PART NO.: HDRXXXPH0000000900000072	
UNIT: mm [inch] SCALE: 1:1 A版	REMARK		MOULD NO.		